

Royale Jardin

PROJECT BY



AATREY ENTERPRISES
Visit us at : www.shreeminfra.in

PROJECT CONSULTANT



Mohan Agrawal

ARCHITECT



DIVYESH DESAI & ASSOCIATES
ARCHITECTS • ENGINEERS • INTERIOR DESIGNERS

3D Impact design +91 8140291255
design hiten arch +91 992233555

Centrally Located Living



Royale Jardin - Where quality enriches life...



3 & 4 BHK Living

*Making a strong statement with
outstanding architectural design.*

*Royale Jardin stands out as a new landmark development setting
unrivalled standards for contemporary living in a prominent and
significant area of Ahmedabad.*



Apartment life with Villa life style



The magnificent Entrance plaza



Building Entrance view



Lifestyle entrance foyer with grand lounge

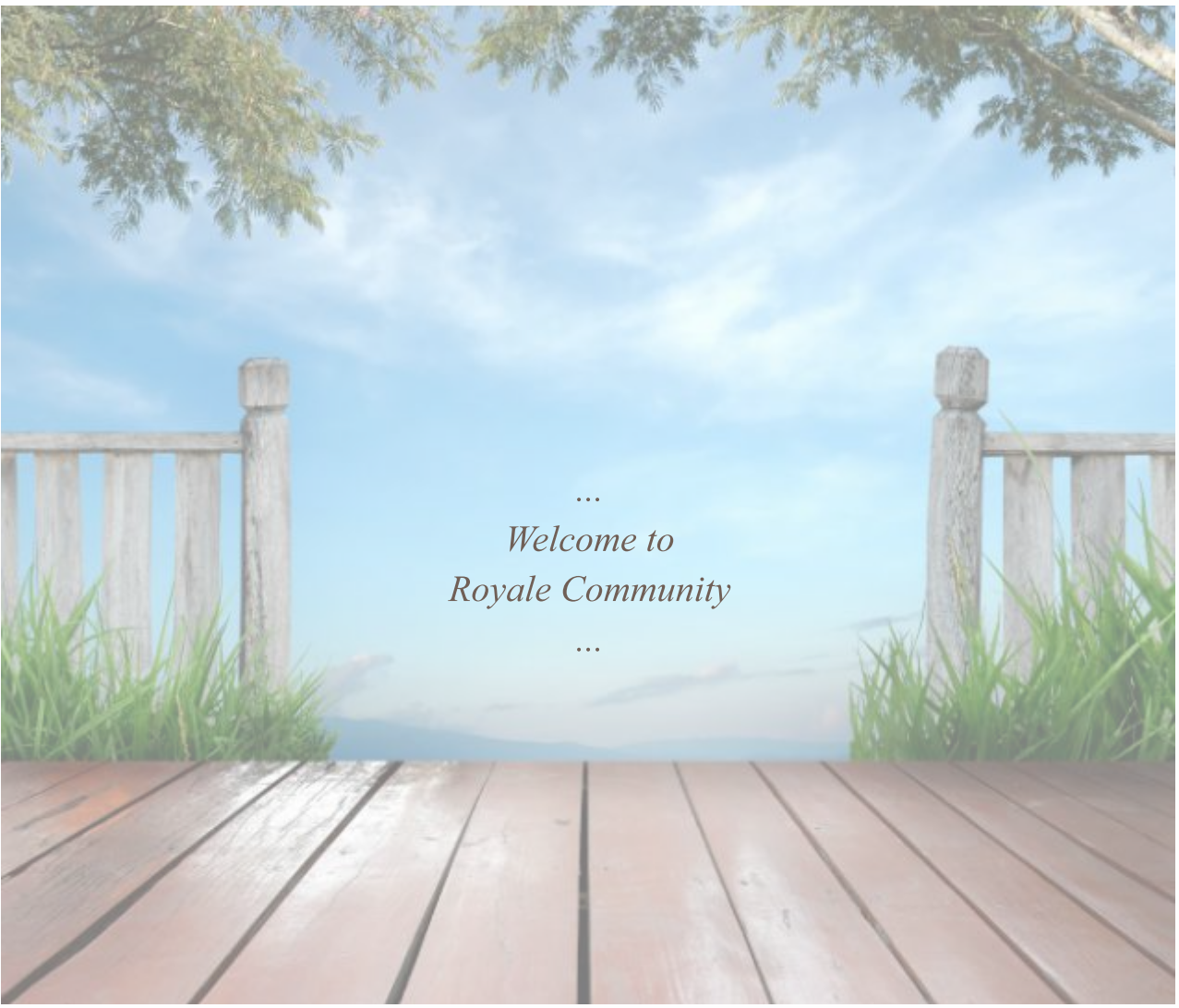



Lifestyle lush green lawn and swimming pool...

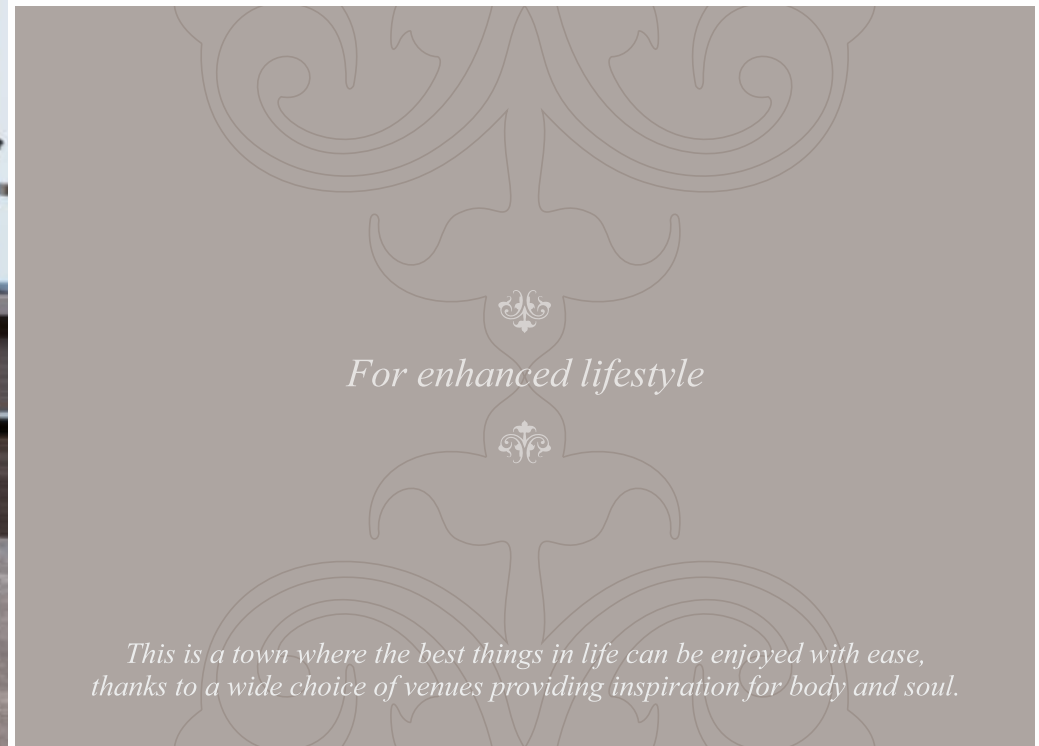
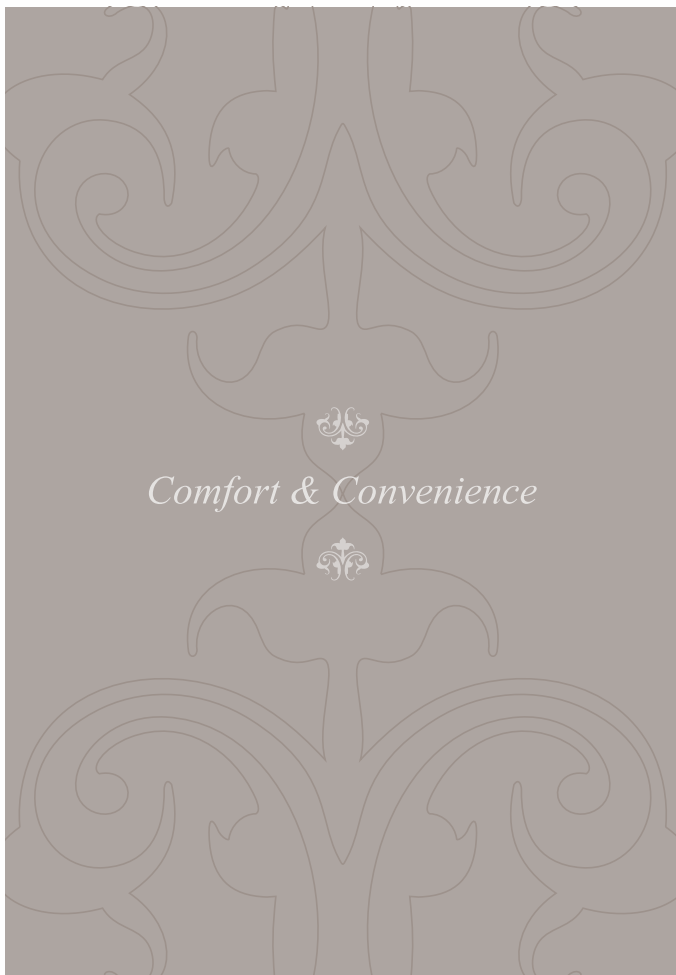



 *Every Precious Moment unforgettable with Grand Banquet Hall..*

Royale Jardin



ROAD

INTERNAL ROAD

GARDEN ENTRY

GARDEN

INFINITY POOL

SWIMMING POOL

WOODEN DECK AREA

POOL LOUNGERS

SHOWER ROOM 4'0" X 2'0"

CHANGING ROOM 4'0" X 2'0"

BANQUET HALL
34'-4" X 26'-5"

LIFT

UP

DN

LIFT

ENTRANCE FOYER
42'-0" X 20'-0"

RECEPTION

GYMNASIUM
13'-5" X 30'-2"

GAME ROOM
20'-8" X 23'-9"

SAUNA BATH

GUEST ROOM-01
10'-4" X 17'-2"

GUEST ROOM-01
10'-4" X 17'-2"

TOILET
4'-5" X 7'-6"

TOILET
4'-6" X 6'-5"

GAZEBO

WALK WAY

RAMP

PARKING

INTERNAL ROAD

INTERNAL ROAD

INTERNAL ROAD

MAIN ENTRY / EXIT GATE

SECURITY CABIN

GROUND FLOOR PLAN





ROAD

INTERNAL ROAD

INTERNAL ROAD

INTERNAL ROAD

INTERNAL ROAD

GARDEN ENTRY

GARDEN

MAIN ENTRY / EXIT GATE

SECURITY CABIN

ENTRANCE FOYER
42'-0" X 19'-5"

LIFT

UP

DN

LIFT

RAMP

GAZEBO

REINITY POOL
SWIMMING POOL

WOODEN DECK AREA

POOL LAUNGERS

SHOWER ROOM
40'0" X 7'0"

CHANGING ROOM
40'0" X 7'0"

1 TO 12TH FLOOR
UNIT PLAN





LEGEND

NO	SPACES	AREA
01	VESTIBULE	5'2" X 6'3"
02	LIVING	12'0" X 19'0"
03	DINING	10'0" X 10'0"
04	KITCHEN	10'0" X 9'0"
4A	STORE	3'9" X 4'3"
4B	WASH	6'9" X 5'8"
05	BALCONY	8'6" X 5'0"
06	BEDROOM - 01	10'0" X 11'0"
07	BEDROOM - 02	11'0" X 15'0"
7A	TOILET	5'0" X 7'6"
08	BEDROOM - 03	11'0" X 13'0"
8A	TOILET	5'0" X 7'2"
09	BEDROOM - 04	14'0" X 11'0"
9A	TOILET	7'0" X 5'0"
10	COMMON TOILET	6'9" X 4'6"

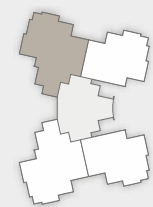

4 bhk apartment



LEGEND

NO	SPACES	AREA
01	LIVING	11'0" X 19'0"
02	DINING	10'0" X 10'0"
03	KITCHEN	10'0" X 9'0"
3A	STORE	3'9" X 4'3"
3B	WASH	6'9" X 5'8"
04	BALCONY	7'6" X 5'0"
05	BEDROOM - 01	10'0" X 11'0"
06	BEDROOM - 02	11'0" X 15'0"
6A	TOILET	5'0" X 7'6"
07	BEDROOM - 03	11'0" X 13'0"
7A	TOILET	5'0" X 7'2"
08	COMMON TOILET	6'9" X 4'6"

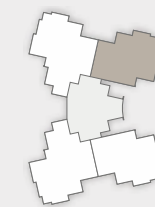

3 bhk apartment



*Spacious
modern
interiors...*



Designed for sheer relaxation, a beautiful, private place in which to enjoy the perfect night's sleep.



13TH FLOOR
PENTHOUSE - UNIT PLAN



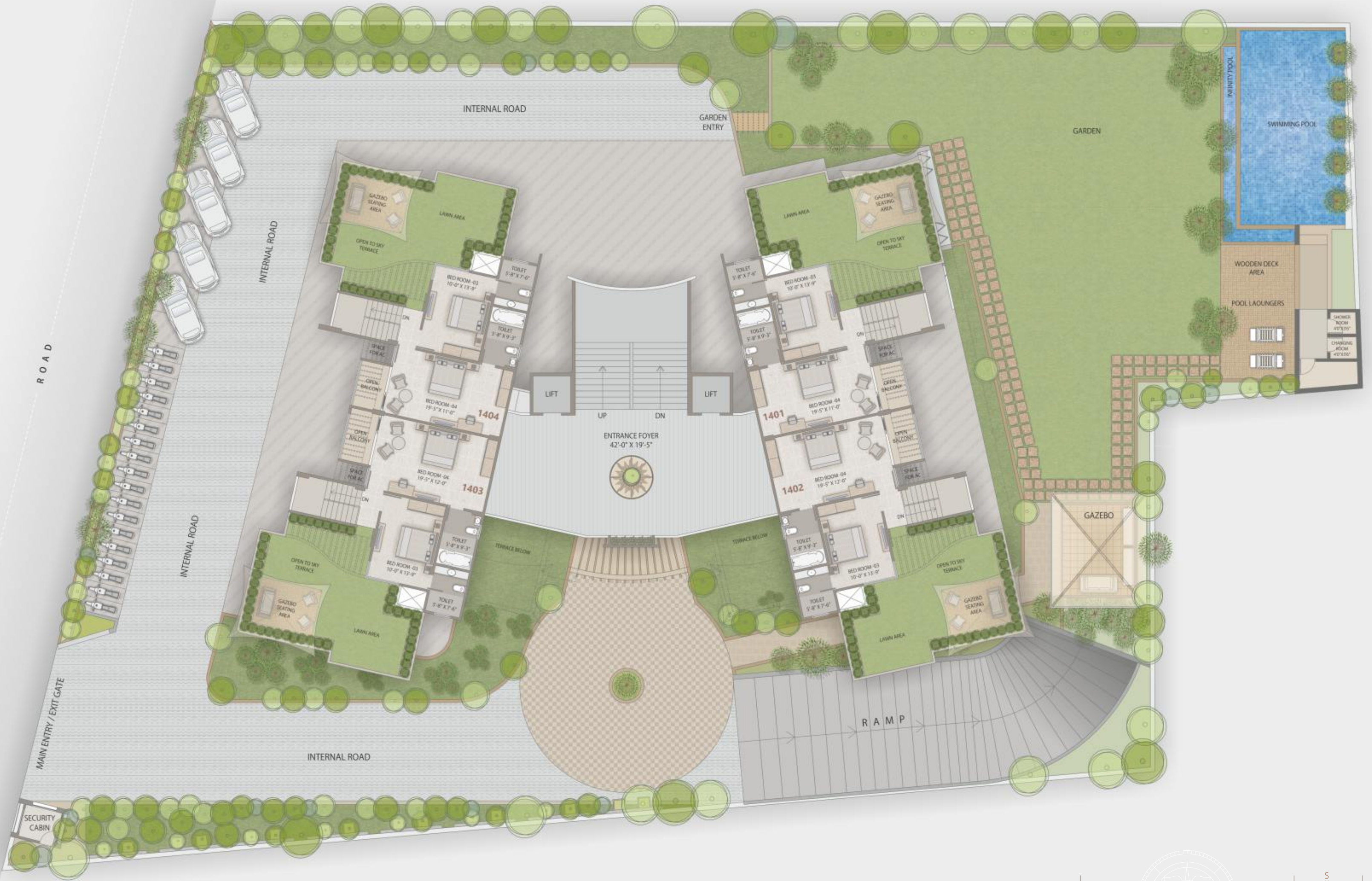

14TH FLOOR
PENTHOUSE - UNIT PLAN



Common amenities

- Beautifully Landscaped Garden.
- Swimming Pool with Deck and Changing Room.
- Attractive Main Entrance Gate with Security Cabin.
- Well Equipped Clubhouse with Gymnasium, Steam Bath, Sauna Bath.
- Indoor Game Room for Chess, Carom & Pool Table.
- Banquet / Multipurpose Hall with Party Lawn.
- Two Fully Furnished Luxurious Guest Rooms.
- Gazebo / Senior Citizen Seating.

Salient features

- Quality Construction with Quality Materials.
- Hollow Plinth plus 1 Level Basement Parking with Mechanical Parking.
- All Internal Roads will be R.C.C. Trimix with Decorative Street Lights.
- 24 Hours Water Supply.
- CCTV Surveillance.
- Intercom Facility.
- Video Door Bell.



Lifestyle facilities

- **Structure :** Earth Quake Resistant R.C.C. Frame Structure.
- **Flooring :** Premium Quality 800 x 800 Vitrified Tiles Flooring.
- **Kitchen :** Granite Platform with Good Quality Stainless Steel Sink and Tile Dado up to Lintel Level.
- **Wall Finish :** Internal - Internal Finish Plaster with Birla Putty. External - Texture with Polymer base Acrylic Paint.
- **Toilet :** Elegantly Designed Toilets with Wall Tiles Dado up to Lintel Level.
- **Doors & Windows :** Decorative Veneered Main Door with Wooden Frame & all other Laminated Flush Doors with Granite Frames. Fully Glazed Anodized Aluminum Windows with Granite Sill & Jamos.
- **Plumbing Fixtures & Fittings :** All Toilets with Concealed Standard Plumbing Line and Branded C.P. Fittings and Sanitary Ware. Granite Counters with Ceramic Wash Basin in all Toilets.
- **Electrical :** Adequate Electric Points with Three Phase ISI Wiring & Modular Switches with A/c Point Provision in Drawing Room & in all Bedrooms. CCTV Camera at Foyer & Intercom Connection in each Apartment from Security Cabin.

Notes : • All rights reserved to organizer for any changes in plan & specification. • Stamp duty, Registration fee, Service tax, miscellaneous etc. for conveyance/sale deed charges will be extra. • VAT if applicable, all fresh levies / taxes or increase in any of the existing levies / taxes, other charges and expenses levied by state, central government or local authorities charges, Narmada water & GSPC Gas Connection Charges will be extra. • Any member who so ever is unable to pay the regular installment is liable to lose the membership and no explanations will be entertained thereafter. • At the time of cancellation of booking 10% service charge of the total amount paid shall be levied & balance payment made only after the next available booking. • Change in external elevation shall not be permitted. Internal changes shall be done only with prior permission & shall be charged extra in advance & no deduction (credit) of specified materials in extra work. • Variation in shades & sizes likely in vitrified & glazed tiles due to constraints of availability & manufacturing. • Details & dimensions in model & brochure are indicative and for the tentative representation only which should not be treated as legal documents or consumer contract. • Possession of the apartment shall be offered only after full payment. • All possible loan papers shall be made available for procuring loans.



 **PENTHOUSE** - The advantage is all yours.

